

**Coffee table / ottoman**  
**+**  
**cord storage and power**

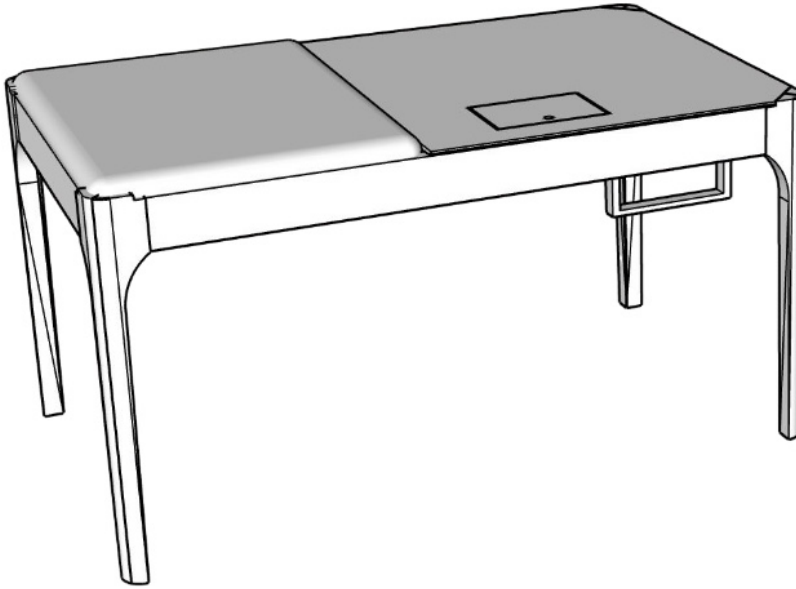

# Coffee table / ottoman + cord storage and power



## Tools

- Table saw
- Bandsaw or Jigsaw
- Circular saw
- Miter Saw
- Clamps
- Chisels
- Spring miter clamps
- Square
- Hand plane
- Router
- 1/8 or 1/4 straight cut router bit
- Electric hand plane (optional)

## Materials

- 5/4 white oak (2 bd ft)
- 4/4 Walnut (5 bd ft)
- Blue tape or double sided tape
- 1/2 in screws
- 1 5/8 in screws
- L Brackets
- AC USB Flush Mount

<https://www.amazon.com/dp/B0B8BMM8FNS?tag=vsidorenko-20>



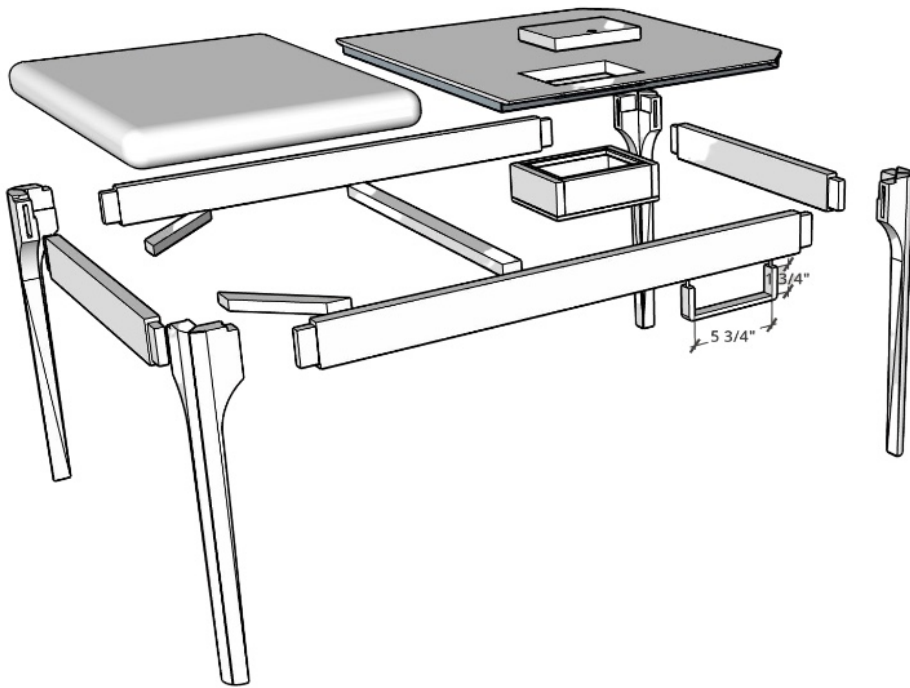

# Directions

## 1 Mill and glue up legs

Rip down strips of your 5/4 white oak to 2 1/2in thick. Next you will want to cut 45° angles on one of the sides.

Cut 8 pieces to 19 in.

Use blue tape so that the miters come together and use spring clamps if you have them.

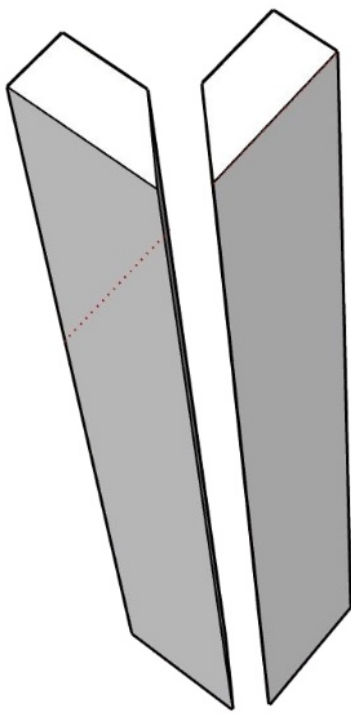

glue up blanks, and use blue tape to line up the miter

## 2 Mark and cut taper and round

I marked the apex of the round out at  $2 \frac{1}{4}$  in the same width that the aprons will be. To draw the radius I used a can that had a radius I thought looked proportionally appropriate.

The bottom of the leg is  $1 \times 1$  so and the taper is  $\frac{1}{4}$  in to the round out.

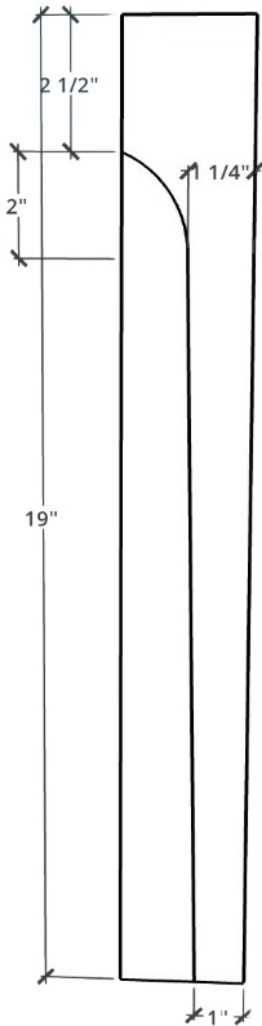

Cut on a band saw or with a jig saw. Once done cutting one side, tape the off cut back where it was cut so that the piece can be stable.

Sand the round out with an orbital sander.

### 3 Rip apron pieces and cut tenons

Rip apron pieces to 2 1/4in wide.

Cut 2 at 33in

Cut 2 at 19

Tenons are 1in length and 1/2in wide

## 4 Mark and cut mortises

I like to match and mark each specific tenon with a mortise.

This takes into account slight variances that might occur.

Mark and cut mortises, take the bulk of the material out with a drill and chisel until you achieve a snug fit.

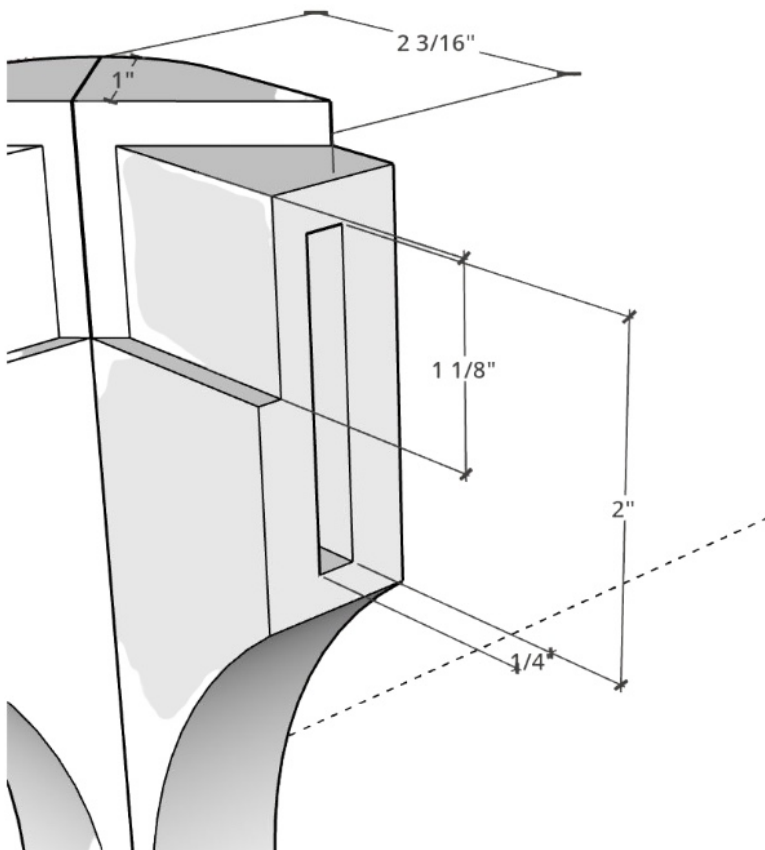

## 5 Add the round over profile

Add the round over profile prior to your glue up. Trace a radius to and use a power planer or a hand plane and plane to the line.

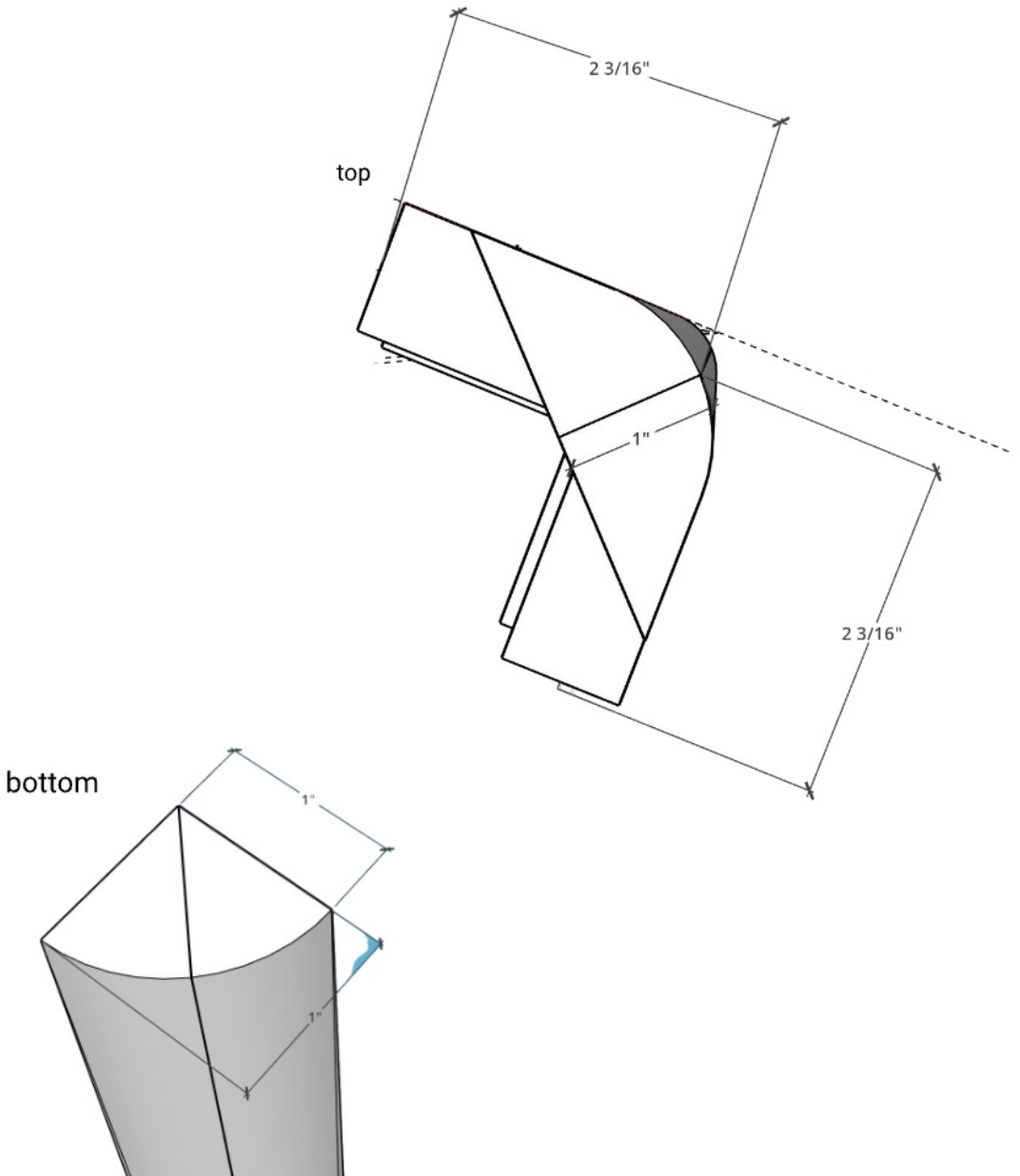

## 6 Glue up frame

I like to glue up one side at a time and then glue the two sides together but you could glue up everything at once.

Make sure to check for square.

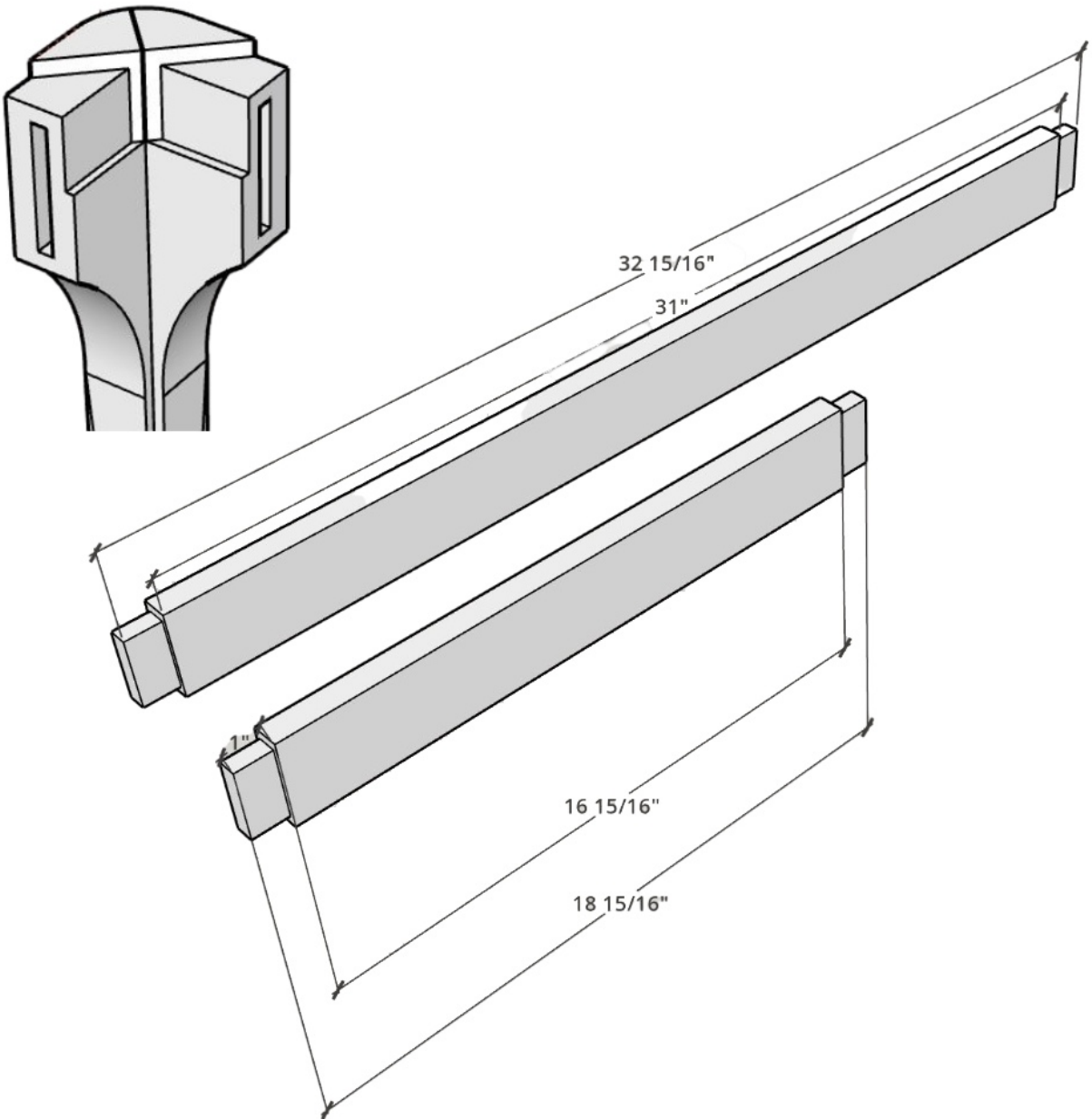



## 7 Glue up the top

Make sure to take a measurement off of your actual frame to get the exact width.

Glue up your top with a final dimension of 22in x 20 1/4.

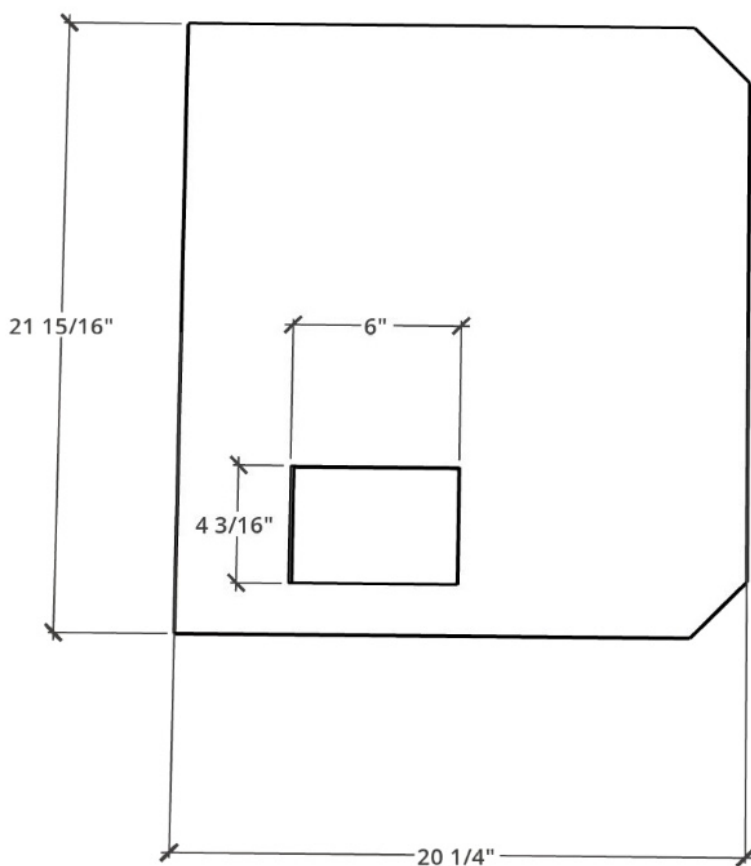

## 8 Rout the cable compartment

I used a 1/4 in router bit and then framed the routed opening with mitered 3/16 in strips to give a 1/16 clearance for the lid

## 9 **Glue strips inside to act as a stop for the lid**

Glue and bradnail strips to act as a stop for the compartment lid.

Use the cut out you made as the lid for a grainmatched fit.

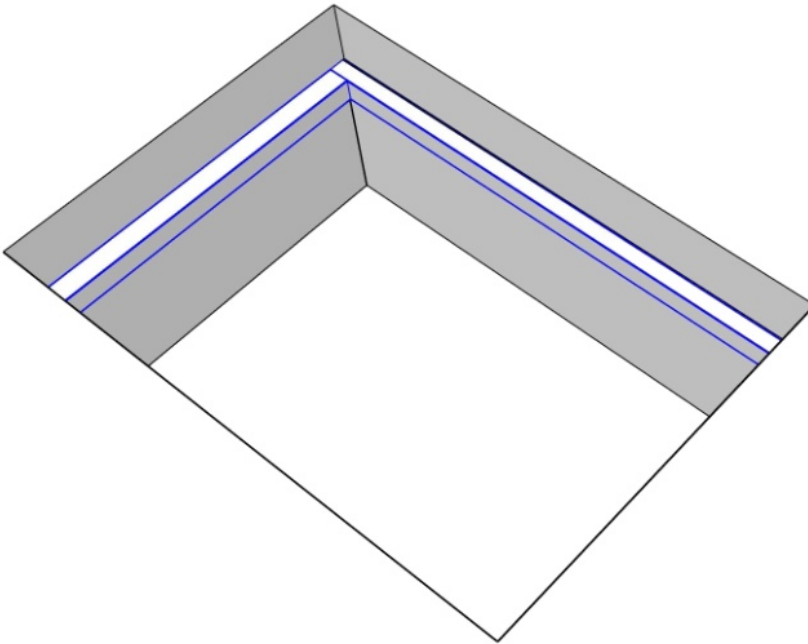

## 10 Secure top and make cushion

Use L brackets to secure top to aprons.



## 11 Make the cushion.

Cut a piece of plywood  $\frac{3}{4}$ in the size of the opening.

I used 3 layers of 1in foam and compressed it with a piece of plywood on the opposite side and used a stapler to secure the fabric.

## **12 Sand and finish the top and base**

Use 120 and work to 240 sand paper.  
I finished with boiled linseed oil but feel free to use your finish of choice.

## **13 Secure the cushion cushion.**

Using the mitered corner braces, secure your cushion using 1 5/8 screws from the bottom.